

NORTH WEST LEICESTERSHIRE DISTRICT COUNCIL

PREMISES LICENCE

Premises Licence Number

NWL20498

Part 1 – Premises Details

Postal address of premises, or if none, ordnance survey map reference or description, including Post Town, Post Code

Brew.
106b Market Street
Ashby De La Zouch
Leicestershire
LE65 1AP

Telephone number:

Where the licence is time limited the dates: Not applicable

Licensable activities authorised by the licence and the times the licence authorises the carrying out of licensable activities

Supply by retail of alcohol:

Monday to Thursday	10:30 - 18:00 hrs
Friday and Saturday	10:30 - 19:00 hrs

Playing of Recorded Music:

Monday to Thursday	10:30 - 18:00 hrs
Friday and Saturday	10:30 - 19:00 hrs

The opening hours of the premises

Monday to Thursday	10:30	18:00 hrs
Friday and Saturday	10:30	19:00 hrs

Where the licence authorises supplies of alcohol whether these are on and / or off supplies

The sale by retail of alcohol for consumption off the premises only.

Part 2

Name, (registered) address, telephone number and email (where relevant) of holder of premises licence

Mr Ellis Wigstead
71 Swallowdale
Thringstone
Leicestershire
LE67 8LY

Registered number of holder, for example company number, charity number (where applicable)

Name, address and telephone number of designated premises supervisor where the premises licence authorises for the supply of alcohol

Mr Ellis Wigstead
71 Swallowdale
Thringstone
Leicestershire
LE67 8LY

Personal licence number and issuing Authority of personal licence held by designated premises supervisor where the premises licence authorises for the supply of alcohol

Personal Licence number of Designated Premises Supervisor: NWL11300

Issuing Authority: North West Leicestershire District Council

Dated: 29th January 2019

Paul Dennis
Licensing Enforcement Officer

Annex 1 – Mandatory conditions

- 1) No supply of alcohol may be made under the premises licence;
 - a) at a time when there is no designated premises supervisor in respect of the premises licence, or
 - b) at a time when the designated premises supervisor does not hold a personal licence or his personal licence is suspended.
- 2) Every supply of alcohol must be made or authorised by a person who holds a personal licence.
- 3) Mandatory condition coming into force from 28th May 2014:
 1. A relevant person shall ensure that no alcohol is sold or supplied for consumption on or off the premises for a price which is less than the permitted price.
 2. For the purposes of the condition set out in paragraph 1—
 - (a) "duty" is to be construed in accordance with the Alcoholic Liquor Duties Act 1979;
 - (b) "permitted price" is the price found by applying the formula—
$$P = D + (D \times V)$$
where—
 - (i) P is the permitted price,
 - (ii) D is the amount of duty chargeable in relation to the alcohol as if the duty were charged on the date of the sale or supply of the alcohol, and
 - (iii) V is the rate of value added tax chargeable in relation to the alcohol as if the value added tax were charged on the date of the sale or supply of the alcohol;
 - (c) "relevant person" means, in relation to premises in respect of which there is in force a premises licence—
 - (i) the holder of the premises licence,
 - (ii) the designated premises supervisor (if any) in respect of such a licence, or
 - (iii) the personal licence holder who makes or authorises a supply of alcohol under such a licence;
 - (d) "relevant person" means, in relation to premises in respect of which there is in force a club premises certificate, any member or officer of the club present on the premises in a capacity which enables the member or officer to prevent the supply in question; and
 - (e) "value added tax" means value added tax charged in accordance with the Value Added Tax Act 1994.
 3. Where the permitted price given by Paragraph (b) of paragraph 2 would (apart from this paragraph) not be a whole number of pennies, the price given by that sub-paragraph shall be taken to be the price actually given by that sub-paragraph rounded up to the nearest penny.
 4. (1) Sub-paragraph (2) applies where the permitted price given by Paragraph (b) of paragraph 2 on a day ("the first day") would be different from the permitted price on the next day ("the second day") as a result of a change to the rate of duty or value added tax.
(2) The permitted price which would apply on the first day applies to sales or supplies of alcohol which take place before the expiry of the period of 14 days beginning on the second day.

4) Mandatory condition coming into force from 1st October 2014:

1. (1) The responsible person must ensure that staff on relevant premises do not carry out, arrange or participate in any irresponsible promotions in relation to the premises.

(2) In this paragraph, an irresponsible promotion means any one or more of the following activities, or substantially similar activities, carried on for the purpose of encouraging the sale or supply of alcohol for consumption on the premises—

(a) games or other activities which require or encourage, or are designed to require or encourage, individuals to—

(i) drink a quantity of alcohol within a time limit (other than to drink alcohol sold or supplied on the premises before the cessation of the period in which the responsible person is authorised to sell or supply alcohol), or

(ii) drink as much alcohol as possible (whether within a time limit or otherwise);

(b) provision of unlimited or unspecified quantities of alcohol free or for a fixed or discounted fee to the public or to a group defined by a particular characteristic in a manner which carries a significant risk of undermining a licensing objective;

(c) provision of free or discounted alcohol or any other thing as a prize to encourage or reward the purchase and consumption of alcohol over a period of 24 hours or less in a manner which carries a significant risk of undermining a licensing objective;

(d) selling or supplying alcohol in association with promotional posters or flyers on, or in the vicinity of, the premises which can reasonably be considered to condone, encourage or glamorise anti-social behaviour or to refer to the effects of drunkenness in any favourable manner;

(e) dispensing alcohol directly by one person into the mouth of another (other than where that other person is unable to drink without assistance by reason of disability).

2. The responsible person must ensure that free potable water is provided on request to customers where it is reasonably available.

3. (1) The premises licence holder or club premises certificate holder must ensure that an age verification policy is adopted in respect of the premises in relation to the sale or supply of alcohol.

(2) The designated premises supervisor in relation to the premises licence must ensure that the supply of alcohol at the premises is carried on in accordance with the age verification policy.

(3) The policy must require individuals who appear to the responsible person to be under 18 years of age (or such older age as may be specified in the policy) to produce on request, before being served alcohol, identification bearing their photograph, date of birth and either—

(a) a holographic mark, or

(b) an ultraviolet feature.

4. The responsible person must ensure that—

(a) where any of the following alcoholic drinks is sold or supplied for consumption on the premises (other than alcoholic drinks sold or supplied having been made up in advance ready for sale or supply in a securely closed container) it is available to customers in the following measures—

(i) beer or cider: ½ pint;

(ii) gin, rum, vodka or whisky: 25 ml or 35 ml; and

(iii) still wine in a glass: 125 ml;

(b) these measures are displayed in a menu, price list or other printed material which is available to customers on the premises; and

(c) where a customer does not in relation to a sale of alcohol specify the quantity of alcohol to be sold, the customer is made aware that these measures are available.

Annex 2 – Conditions consistent with the Operating Schedule

- 1) CCTV shall be installed, maintained and a member of trained staff shall be onsite at all times, who is able to operate it in the event of an incident.
- 2) No one under the age of 18 years shall be permitted on to the premises unless accompanied by an adult.
- 3) The premise licence holder shall promote management controls and effective training of all staff so that they are aware of the premises licence and the requirements to meeting the licensing objectives. This training will be documented and available to view by authorised officers on request.
- 4) Deliveries of goods necessary for the operation of the business shall be carried out at such time or in such a manner to cause minimal disruption and disturbance to nearby residents.
- 5) A Challenge 25 policy shall be operated at the premises at all times. All staff shall require identification of all customers who appear to be less than 25 years old and wish to purchase alcohol. Acceptable proof of age will be a photographic driving licence, passport, PASS approved proof of age card, Military ID and any other locally or nationally approved form of identification.
- 6) The premise licence holder shall ensure that the immediate area outside the premises is kept free of litter.
- 7) All incidents, refusals and accidents which arise at the premises shall be logged.
- 8) Alcohol sold for consumption off the premises shall be sold in sealed containers.

Annex 3 – Conditions attached after a hearing by the licensing authority

Annex 4 – Plans

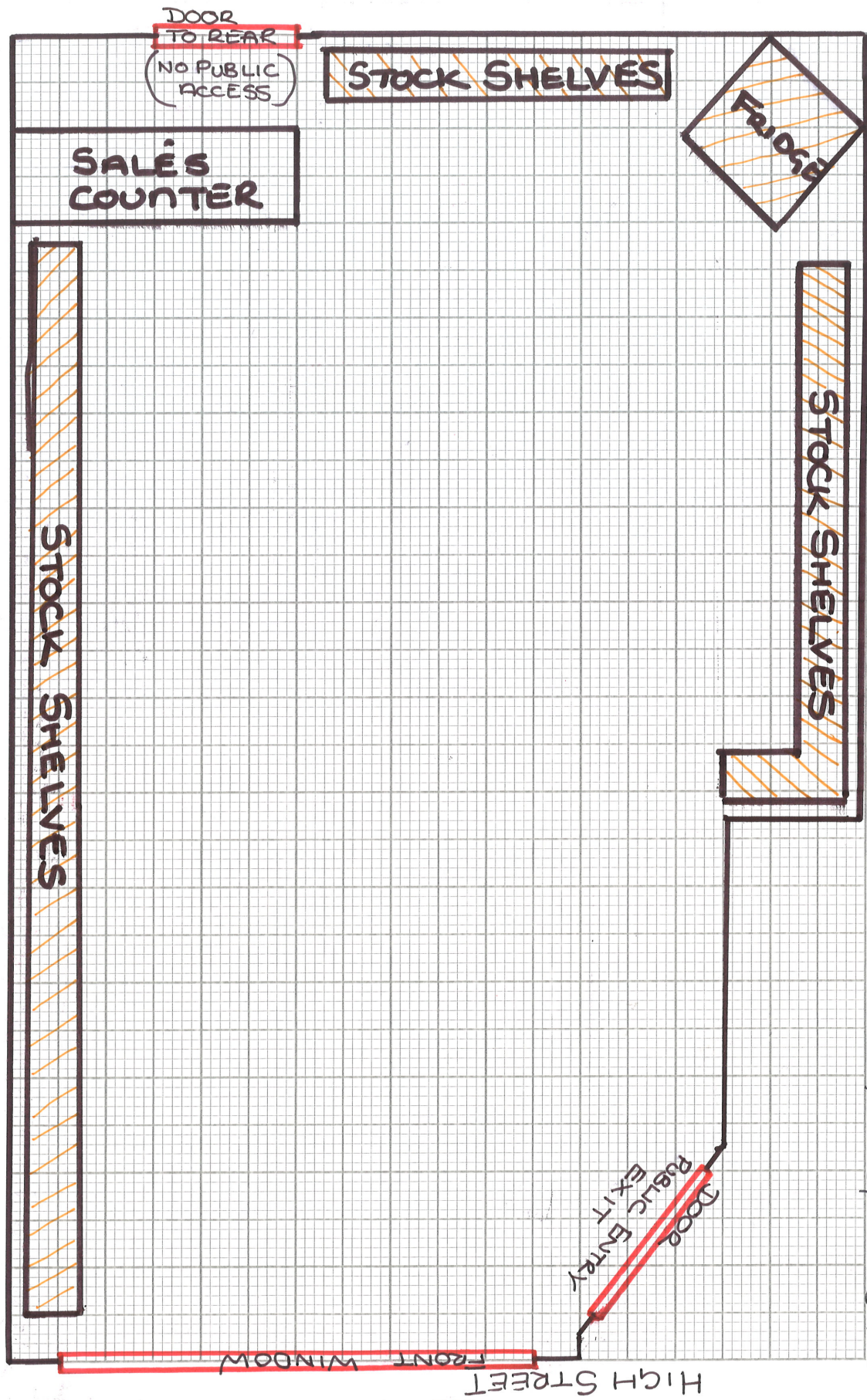

SHOP LAY-OUT PLAN'S 106b MARKET STREET, ASHBY LANE 1AP

SHOP LAY-OUT PLAN'S 106b MARKET STREET, ASHBY LE65 1AP

